

SOLID WORM SHAFT DIMENSIONS

| SIZE | BRG1 +.0000 -.0005 | BRG2 +.0000 -.0005 | CD | D +.000 -.004 | F | J | L1 | L3 | M | P | SIZE |
|------|--------------------------|--------------------------|-------|---------------------|------|------|-------|------|------|------|------|
| 913 | .6696 | .6696 | 1.333 | 2.717 | 1.19 | 2.88 | 6.26 | .67 | 4.12 | .63 | 913 |
| 917 | .9848 | .9848 | 1.750 | 3.662 | 1.25 | 3.06 | 7.53 | .81 | 4.75 | .63 | 917 |
| 920 | .7879 | .9848 | 2.000 | 3.662 | 1.25 | 3.31 | 7.78 | .81 | 5.00 | .69 | 920 |
| 924 | 1.3785 | 1.3785 | 2.375 | 4.783 | 1.50 | 4.13 | 9.84 | .94 | 6.50 | .75 | 924 |
| 926 | 1.3785 | 1.3785 | 2.625 | 4.783 | 1.50 | 4.13 | 9.84 | .94 | 6.50 | .75 | 926 |
| 930 | 1.3785 | 1.5753 | 3.000 | 4.925 | 1.94 | 4.56 | 10.69 | 1.20 | 7.00 | 1.26 | 930 |
| 935 | 1.3140 | 1.3140 | 3.500 | 5.779 | 1.80 | 4.49 | 11.13 | .86 | 7.38 | .96 | 935 |
| 943 | 1.3765 | 1.3765 | 4.250 | 7.144 | .98 | 4.62 | 12.75 | .99 | 8.19 | 1.00 | 943 |

| SIZE | R +.000 -.002 | R1 +.000 -.008 | R2 +.000 -.006 | S | S1 | T +.000 -.001 | U +.000 -.001 | V | KEYWAY | SIZE |
|------|---------------------|----------------------|----------------------|------|------|---------------------|---------------------|------|-------------|------|
| 913 | .571 | .056 | .641 | .81 | .81 | .668 | .625 | 1.63 | 3/16 x 3/32 | 913 |
| 917 | .716 | .063 | .943 | 1.19 | 1.19 | .984 | .750 | 1.69 | 3/16 x 3/32 | 917 |
| 920 | .716 | .063 | .748 | 1.00 | 1.19 | .984 | .750 | 1.75 | 3/16 x 3/32 | 920 |
| 924 | .823 | .072 | 1.314 | 1.56 | 1.56 | 1.375 | 1.000 | 2.38 | 1/4 x 1/8 | 924 |
| 926 | .823 | .072 | 1.314 | 1.56 | 1.56 | 1.375 | 1.000 | 2.38 | 1/4 x 1/8 | 926 |
| 930 | 1.024 | .108 | 1.293 | 1.72 | 1.76 | 1.375 | 1.000 | 2.38 | 1/4 x 1/8 | 930 |
| 935 | NA | NA | NA | 1.70 | 1.70 | 1.250 | 1.000 | 2.50 | 1/4 x 1/8 | 935 |
| 943 | NA | NA | NA | 1.92 | 1.92 | 1.250 | 1.250 | 2.50 | 1/4 x 1/8 | 943 |



SOLID WORM SHAFT RATIO CHART

| SIZE 913 | | | | SIZE 917 | | | | SIZE 920 | | | |
|----------|-------|------|-----|----------|-------|------|------|----------|-------|------|------|
| RATIO | WORM | | | RATIO | WORM | | | RATIO | WORM | | |
| | OD | L | C | | OD | L | C | | OD | L | C |
| 4 | 1.180 | 1.15 | .66 | 4 | 1.617 | 1.17 | 1.10 | 4 | 1.158 | 1.79 | 1.79 |
| 5 | .927 | .98 | .75 | 5 | 1.227 | 1.17 | 1.10 | 5 | 1.402 | 1.32 | 1.02 |
| 7.5 | .788 | .89 | .79 | 7.5 | .954 | 1.24 | 1.06 | 7.5 | 1.090 | 1.39 | .98 |
| 10 | .788 | .89 | .79 | 10 | .874 | 1.25 | 1.06 | 10 | .991 | 1.48 | .94 |
| 15 | .788 | .89 | .79 | 15 | .874 | 1.25 | 1.06 | 15 | .991 | 1.48 | .94 |
| 20 | .731 | 1.02 | .73 | 20 | .793 | .95 | 1.21 | 20 | .910 | 1.16 | 1.10 |
| 25 | .697 | 1.02 | .73 | 25 | .745 | .76 | 1.30 | 25 | .835 | .91 | 1.23 |
| 30 | .801 | 1.02 | .73 | 30 | .891 | 1.28 | 1.04 | 30 | 1.034 | 1.56 | .90 |
| 40 | .731 | 1.02 | .73 | 40 | .793 | 1.02 | 1.17 | 40 | .926 | 1.19 | 1.09 |
| 50 | .697 | 1.02 | .73 | 50 | .745 | 1.02 | 1.17 | 50 | .835 | 1.25 | 1.06 |
| 60 | .674 | 1.02 | .73 | 60 | .714 | 1.02 | 1.17 | 60 | .795 | 1.25 | 1.06 |
| 80 | NA | NA | NA | 80 | .674 | .50 | 1.43 | 80 | .697 | .53 | 1.41 |
| 100 | NA | NA | NA | 100 | .558 | .50 | 1.43 | 100 | .674 | .53 | 1.42 |

| SIZE 924 | | | | SIZE 926 | | | | SIZE 930 | | | |
|----------|-------|------|------|----------|-------|------|------|----------|-------|------|------|
| RATIO | WORM | | | RATIO | WORM | | | RATIO | WORM | | |
| | OD | L | C | | OD | L | C | | OD | L | C |
| 4 | 1.481 | 1.26 | 2.29 | 4 | 2.064 | 1.78 | 1.22 | 4 | 2.296 | 2.27 | 1.33 |
| 5 | 1.625 | 1.30 | 1.72 | 5 | 1.809 | 1.47 | 1.64 | 5 | 2.067 | 1.69 | 1.58 |
| 7.5 | 1.308 | 1.69 | 1.53 | 7.5 | 1.446 | 1.87 | 1.44 | 7.5 | 1.671 | 2.21 | 1.32 |
| 10 | 1.154 | 1.77 | 1.49 | 10 | 1.251 | 1.97 | 1.40 | 10 | 1.465 | 2.31 | 1.26 |
| 15 | 1.205 | 1.87 | 1.44 | 15 | 1.306 | 2.07 | 1.34 | 15 | 1.497 | 2.37 | 1.23 |
| 20 | 1.077 | 1.41 | 1.67 | 20 | 1.167 | 1.57 | 1.59 | 20 | 1.334 | 1.79 | 1.52 |
| 25 | .999 | 1.14 | 1.80 | 25 | 1.062 | 1.75 | 1.49 | 25 | 1.216 | 1.40 | 1.72 |
| 30 | 1.205 | 1.87 | 1.44 | 30 | 1.306 | 2.07 | 1.34 | 30 | 1.497 | 2.37 | 1.23 |
| 40 | 1.077 | 1.50 | 1.50 | 40 | 1.167 | 1.75 | 1.49 | 40 | 1.334 | 1.79 | 1.52 |
| 50 | .967 | 1.50 | 1.50 | 50 | 1.062 | 1.75 | 1.49 | 50 | 1.216 | 2.25 | 1.31 |
| 60 | .920 | 1.50 | 1.50 | 60 | .992 | 1.75 | 1.49 | 60 | 1.135 | 1.75 | 1.56 |
| 80 | .851 | .66 | 2.04 | 80 | .915 | .73 | 2.02 | 80 | 1.047 | 1.18 | 1.85 |
| 100 | .817 | .52 | 2.11 | 100 | .878 | .58 | 2.09 | 100 | 1.004 | .67 | 1.96 |

| SIZE 935 | | | | SIZE 943 | | | |
|----------|-------|------|------|----------|-------|------|------|
| RATIO | WORM | | | RATIO | WORM | | |
| | OD | L | C | | OD | L | C |
| 4 | 2.600 | 2.77 | 1.50 | 4 | 2.722 | 3.67 | 1.74 |
| 5 | 2.411 | 1.61 | 2.08 | 5 | 2.476 | 2.87 | 2.14 |
| 7.5 | 1.949 | 2.17 | 1.80 | 7.5 | 2.509 | 3.33 | 1.91 |
| 10 | 1.908 | 2.25 | 1.76 | 10 | 2.509 | 3.33 | 1.91 |
| 15 | 1.908 | 2.25 | 1.76 | 15 | 2.509 | 3.33 | 1.91 |
| 20 | 1.683 | 1.71 | 2.03 | 20 | 2.245 | 2.65 | 2.26 |
| 25 | 1.545 | 1.38 | 2.20 | 25 | 2.592 | 3.57 | 1.80 |
| 30 | 1.908 | 2.25 | 1.76 | 30 | 2.509 | 3.33 | 1.91 |
| 40 | 1.683 | 1.71 | 2.03 | 40 | 2.245 | 2.65 | 2.26 |
| 50 | 1.545 | 1.38 | 2.20 | 50 | 2.083 | 2.25 | 2.46 |
| 60 | 1.452 | 1.16 | 2.31 | 60 | 1.973 | 1.83 | 2.67 |
| 80 | 1.333 | .88 | 2.44 | 80 | 1.833 | 1.63 | 2.77 |
| 100 | 1.261 | .71 | 2.53 | 100 | 1.748 | 1.50 | 2.83 |

Material—8620 vacuum carburized and hardened
 Mechanical ratings are available in the unit rating section by size and ratio
 Check with factory for other dimensions
 WINSMITH® reserves the right to change dimensions without prior notice

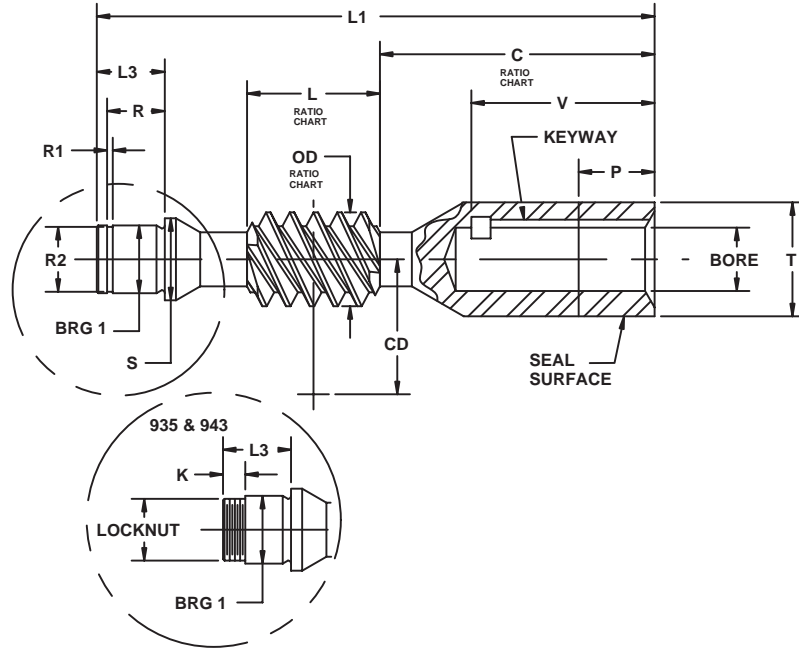

QUILL WORM DIMENSIONS

| SIZE | BRG1 +.0000 -.0005 | CD | K | LOCKNUT | L1 | L3 | P | R +.000 -.002 | R1 +.000 -.008 | R2 +.000 -.006 | S | SIZE |
|------|--------------------------|-------|-----|---------|-------|------|------|---------------------|----------------------|----------------------|------|------|
| 913 | .6696 | 1.333 | NA | NA | 5.26 | .67 | .75 | .571 | .056 | .641 | .81 | 913 |
| 917 | .9848 | 1.750 | NA | NA | 6.47 | .81 | .75 | .716 | .063 | .943 | 1.19 | 917 |
| 920 | .7879 | 2.000 | NA | NA | 6.47 | .81 | .75 | .716 | .063 | .748 | 1.00 | 920 |
| 924 | 1.3785 | 2.375 | NA | NA | 8.34 | .94 | 1.00 | .823 | .072 | 1.314 | 1.56 | 924 |
| 926 | 1.3785 | 2.625 | NA | NA | 8.34 | .94 | 1.00 | .823 | .072 | 1.314 | 1.56 | 926 |
| 930 | 1.3785 | 3.000 | NA | NA | 8.88 | 1.20 | 1.00 | 1.024 | .108 | 1.293 | 1.72 | 930 |
| 935 | 1.3125 | 3.500 | .69 | N-06 | 10.31 | 2.31 | 1.00 | NA | NA | NA | 1.63 | 935 |
| 943 | 1.3750 | 4.250 | .63 | N-06 | 12.00 | 2.50 | 1.00 | NA | NA | NA | 1.69 | 943 |

| SIZE | FRAME NO. | BORE +.001 -.000 | KEYWAY | T +.000 -.001 | V |
|-------------------|----------------|------------------------|-------------|---------------------|------|
| 913 | 48C | .5005 | 1/8 x 1/16 | 1.125 | 1.44 |
| | 56C | .6255 | 3/16 x 3/32 | | 1.75 |
| 917 | 48C | .5005 | 1/8 x 1/16 | 1.375 | 1.44 |
| | 56C | .6255 | 3/16 x 3/32 | | 1.88 |
| | 143TC 145TC | .8755 | | | 1.94 |
| 920 | 48C | .5005 | 1/8 x 1/16 | 1.375 | 1.44 |
| | 56C | .6255 | 3/16 x 3/32 | | 1.88 |
| | 143TC 145TC | .8755 | | | 1.94 |
| 924 926 930 | 56C | .6255 | 3/16 x 3/32 | 1.750 | 1.88 |
| | 143TC 145TC | .8755 | | | 1.94 |
| | 182TC 184TC | 1.1255 | 1/4 x 1/8 | | 2.44 |

| SIZE | FRAME NO. | BORE +.001 -.000 | KEYWAY | T +.000 -.001 | V |
|----------------|----------------|------------------------|-------------|---------------------|-------|
| 935 | 56C | .6255 | 3/16 x 3/32 | 1.750 | 1.63 |
| | 143TC 145TC | .8755 | | | 1.69 |
| | 182TC 184TC | 1.1255 | 1/4 x 1/8 | | 2.31 |
| | 56C | .6255 | 3/16 x 3/32 | | 1.88 |
| 143TC 145TC | .8755 | 1.94 | | | |
| 943 | 182TC 184TC | 1.1255 | 1/4 x 1/8 | 1.750 | 2.44 |
| | 213TC 215TC | 1.3755 | 5/16 x 5/32 | | 2.375 |
| | | | | | 3.06 |



QUILL WORM RATIO CHART

| SIZE 913 | | | | SIZE 917 | | | | SIZE 920 | | | |
|----------|-------|------|------|----------|-------|------|------|----------|-------|------|------|
| RATIO | WORM | | | RATIO | WORM | | | RATIO | WORM | | |
| | OD | L | C | | OD | L | C | | OD | L | C |
| 4 | 1.180 | 1.15 | 2.54 | 4 | 1.617 | 1.17 | 3.11 | 4 | 1.158 | 1.79 | 2.96 |
| 5 | .927 | .98 | 2.63 | 5 | 1.227 | 1.17 | 3.10 | 5 | 1.402 | 1.32 | 3.02 |
| 7.5 | .788 | .89 | 2.67 | 7.5 | .954 | 1.24 | 3.06 | 7.5 | 1.090 | 1.39 | 2.99 |
| 10 | .788 | .89 | 2.67 | 10 | .874 | 1.25 | 3.06 | 10 | .991 | 1.48 | 2.94 |
| 15 | .788 | .89 | 2.67 | 15 | .874 | 1.25 | 3.06 | 15 | .991 | 1.48 | 2.94 |
| 20 | .731 | 1.02 | 2.61 | 20 | .795 | 1.02 | 3.17 | 20 | .910 | 1.16 | 3.11 |
| 25 | .697 | 1.02 | 2.61 | 25 | .745 | 1.02 | 3.17 | 25 | .835 | .91 | 3.23 |
| 30 | .801 | 1.02 | 2.61 | 30 | .891 | 1.28 | 3.04 | 30 | 1.034 | 1.56 | 2.90 |
| 40 | .731 | 1.02 | 2.61 | 40 | .793 | 1.02 | 3.17 | 40 | .926 | 1.19 | 3.09 |
| 50 | .697 | 1.02 | 2.61 | 50 | .745 | 1.02 | 3.17 | 50 | .835 | 1.25 | 3.06 |
| 60 | .674 | 1.02 | 2.61 | 60 | .714 | 1.02 | 3.17 | 60 | .795 | 1.25 | 3.06 |
| 80 | NA | NA | NA | 80 | .674 | .50 | 3.43 | 80 | .697 | .53 | 3.42 |
| 100 | NA | NA | NA | 100 | .558 | .50 | 3.43 | 100 | .674 | .53 | 3.42 |

| SIZE 924 | | | | SIZE 926 | | | | SIZE 930 | | | |
|----------|-------|------|------|----------|-------|------|------|----------|-------|------|------|
| RATIO | WORM | | | RATIO | WORM | | | RATIO | WORM | | |
| | OD | L | C | | OD | L | C | | OD | L | C |
| 4 | 1.481 | 2.29 | 3.88 | 4 | 2.064 | 1.78 | 4.11 | 4 | 2.296 | 2.27 | 4.00 |
| 5 | 1.625 | 1.30 | 4.35 | 5 | 1.809 | 1.47 | 4.26 | 5 | 2.067 | 1.69 | 4.33 |
| 7.5 | 1.308 | 1.69 | 4.15 | 7.5 | 1.446 | 1.87 | 4.06 | 7.5 | 1.671 | 2.21 | 4.07 |
| 10 | 1.154 | 1.77 | 4.12 | 10 | 1.251 | 1.97 | 4.02 | 10 | 1.465 | 2.31 | 4.02 |
| 15 | 1.205 | 1.87 | 4.07 | 15 | 1.306 | 2.07 | 3.96 | 15 | 1.497 | 2.37 | 3.99 |
| 20 | 1.077 | 1.41 | 4.30 | 20 | 1.167 | 1.57 | 4.20 | 20 | 1.334 | 1.79 | 4.28 |
| 25 | .999 | 1.14 | 4.43 | 25 | 1.063 | 1.75 | 4.11 | 25 | 1.216 | 1.40 | 4.47 |
| 30 | 1.205 | 1.87 | 4.07 | 30 | 1.306 | 2.07 | 3.96 | 30 | 1.497 | 2.37 | 3.99 |
| 40 | 1.077 | 1.50 | 4.24 | 40 | 1.167 | 1.75 | 4.11 | 40 | 1.334 | 1.79 | 4.28 |
| 50 | .967 | 1.50 | 4.24 | 50 | 1.062 | 1.75 | 4.11 | 50 | 1.216 | 2.25 | 4.06 |
| 60 | .920 | 1.50 | 4.24 | 60 | .992 | 1.75 | 4.11 | 60 | 1.135 | 1.75 | 4.31 |
| 80 | .851 | .66 | 4.67 | 80 | .915 | .73 | 4.64 | 80 | 1.047 | 1.18 | 4.60 |
| 100 | .817 | .52 | 4.74 | 100 | .878 | .58 | 4.71 | 100 | 1.004 | .92 | 4.72 |

| SIZE 935 | | | | SIZE 943 | | | | | |
|----------|-------|------|------|----------|---------|-----------|------|-------------|------|
| RATIO | WORM | | | RATIO | WORM OD | 56C-184TC | | 213TC-215TC | |
| | OD | L | C | | | L | C | L | C |
| 4 | 2.600 | 2.77 | 3.72 | 4 | 2.722 | 3.67 | 3.86 | 3.67 | 3.86 |
| 5 | 2.411 | 2.03 | 4.81 | 5 | 2.476 | 2.87 | 4.87 | 3.00 | 4.81 |
| 7.5 | 1.949 | 2.58 | 4.58 | 7.5 | 2.509 | 3.33 | 4.65 | 3.37 | 4.63 |
| 10 | 1.908 | 2.69 | 4.53 | 10 | 2.509 | 3.33 | 4.65 | 3.37 | 4.63 |
| 15 | 1.908 | 2.69 | 4.53 | 15 | 2.509 | 3.33 | 4.65 | 3.37 | 4.63 |
| 20 | 1.683 | 2.05 | 4.85 | 20 | 2.245 | 2.65 | 4.99 | 2.90 | 4.86 |
| 25 | 1.545 | 1.65 | 5.05 | 25 | 2.592 | 3.57 | 4.53 | 3.57 | 4.53 |
| 30 | 1.908 | 2.69 | 4.53 | 30 | 2.509 | 3.33 | 4.65 | 3.37 | 4.63 |
| 40 | 1.683 | 2.05 | 4.85 | 40 | 2.245 | 2.65 | 4.99 | 2.90 | 4.86 |
| 50 | 1.545 | 1.65 | 5.05 | 50 | 2.083 | 2.25 | 5.19 | 2.95 | 4.84 |
| 60 | 1.452 | 1.39 | 5.18 | 60 | 1.973 | 1.83 | 5.40 | 2.39 | 5.12 |
| 80 | 1.333 | 1.07 | 5.34 | 80 | 1.833 | 1.63 | 5.50 | 1.74 | 5.44 |
| 100 | 1.261 | .85 | 5.45 | 100 | 1.748 | 1.50 | 5.56 | 1.50 | 5.56 |

SOLID SHAFT GEAR

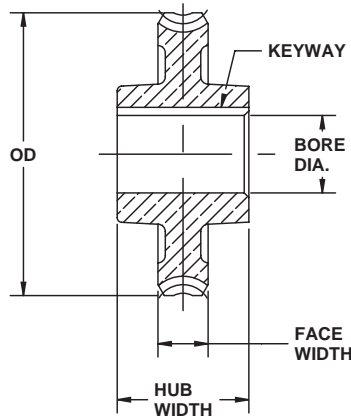

SOLID SHAFT GEAR DIMENSIONS

| SIZE | CD | BORE DIA. | KEYWAY | HUB WIDTH | SIZE | CD | BORE DIA. | KEYWAY | HUB WIDTH |
|------|-------|---------------|-------------|-------------|------|-------|---------------|-------------|-------------|
| 913 | 1.333 | .7506/1.7511 | 3/16 x 3/32 | 1.127/1.123 | 926 | 2.625 | 1.2503/1.2510 | 1/4 x 1/8 | 1.377/1.373 |
| 917 | 1.750 | 1.0004/1.0011 | 1/4 x 1/8 | 1.707/1.703 | 930 | 3.000 | 1.3760/1.3753 | 5/16 x 5/32 | 1.501/1.499 |
| 920 | 2.000 | 1.0004/1.0011 | 1/4 x 1/8 | 1.707/1.703 | 935 | 3.500 | 1.7499/1.7508 | 3/8 x 3/16 | 1.562/1.558 |
| 924 | 2.375 | 1.2503/1.2510 | 1/4 x 1/8 | 1.377/1.373 | 943 | 4.250 | 1.9997/2.0008 | 1/2 x 1/4 | 2.002/1.998 |

GEAR OD & FACE WIDTH

| SIZE | RATIO | | | | | | | | | | | | | | SIZE |
|------|-------|------------------------|-------|------------------------|-------|------------------------|-------|------------------------|-------|------------------------|-------|------------------------|-------|------------------------|------|
| | 4 | | 5 | | 7.5 | | 10 | | 15 | | 20 | | 25 | | |
| | OD | FACE WIDTH SOLID SHAFT | OD | FACE WIDTH SOLID SHAFT | OD | FACE WIDTH SOLID SHAFT | OD | FACE WIDTH SOLID SHAFT | OD | FACE WIDTH SOLID SHAFT | OD | FACE WIDTH SOLID SHAFT | OD | FACE WIDTH SOLID SHAFT | |
| 913 | 1.966 | .56 | 2.070 | .56 | 2.200 | .50 | 2.200 | .50 | 2.200 | .50 | 2.200 | .50 | 2.200 | .50 | 913 |
| 917 | 2.300 | .75 | 2.730 | .75 | 2.941 | .60 | 3.080 | .60 | 3.080 | .60 | 3.080 | .60 | 3.080 | .60 | 917 |
| 920 | 3.487 | .65 | 3.120 | .82 | 3.361 | .65 | 3.560 | .65 | 3.560 | .65 | 3.560 | .65 | 3.560 | .65 | 920 |
| 924 | 4.009 | .80 | 3.660 | 1.00 | 4.009 | .80 | 4.240 | .80 | 4.240 | .80 | 4.240 | .80 | 4.240 | .80 | 924 |
| 926 | 3.766 | 1.00 | 4.060 | 1.06 | 4.431 | .85 | 4.700 | .85 | 4.700 | .85 | 4.700 | .85 | 4.700 | .85 | 926 |
| 930 | 4.484 | 1.25 | 4.640 | 1.25 | 5.087 | .94 | 5.390 | .94 | 5.390 | .94 | 5.390 | .94 | 5.390 | .94 | 930 |
| 935 | 5.400 | 1.40 | 5.364 | 1.40 | 6.035 | 1.05 | 6.035 | 1.05 | 6.035 | 1.05 | 6.035 | 1.05 | 6.035 | 1.05 | 935 |
| 943 | 7.100 | 1.38 | 7.100 | 1.38 | 7.100 | 1.38 | 7.100 | 1.38 | 7.100 | 1.38 | 7.100 | 1.38 | 7.100 | 1.38 | 943 |

| SIZE | RATIO | | | | | | | | | | | | SIZE |
|------|-------|------------------------|-------|------------------------|-------|------------------------|-------|------------------------|-------|------------------------|-------|------------------------|------|
| | 30 | | 40 | | 50 | | 60 | | 80 | | 100 | | |
| | OD | FACE WIDTH SOLID SHAFT | OD | FACE WIDTH SOLID SHAFT | OD | FACE WIDTH SOLID SHAFT | OD | FACE WIDTH SOLID SHAFT | OD | FACE WIDTH SOLID SHAFT | OD | FACE WIDTH SOLID SHAFT | |
| 913 | 2.200 | .50 | 2.200 | .50 | 2.200 | .50 | 2.200 | .50 | 2.200 | .50 | 2.200 | .50 | 913 |
| 917 | 3.080 | .60 | 3.080 | .60 | 3.080 | .60 | 3.080 | .60 | 3.080 | .60 | 3.080 | .60 | 917 |
| 920 | 3.560 | .65 | 3.560 | .65 | 3.560 | .65 | 3.560 | .65 | 3.560 | .65 | 3.560 | .65 | 920 |
| 924 | 4.240 | .80 | 4.240 | .80 | 4.240 | .80 | 4.240 | .80 | 4.240 | .80 | 4.240 | .80 | 924 |
| 926 | 4.700 | .85 | 4.700 | .85 | 4.700 | .85 | 4.700 | .85 | 4.700 | .85 | 4.700 | .85 | 926 |
| 930 | 5.390 | .94 | 5.390 | .94 | 5.390 | .94 | 5.390 | .94 | 5.390 | .94 | 5.390 | .94 | 930 |
| 935 | 6.035 | 1.05 | 6.035 | 1.05 | 6.035 | 1.05 | 6.035 | 1.05 | 6.035 | 1.05 | 6.035 | 1.05 | 935 |
| 943 | 7.100 | 1.38 | 7.100 | 1.38 | 7.100 | 1.38 | 7.100 | 1.38 | 7.100 | 1.38 | 7.100 | 1.38 | 943 |

Material—Chill cast or forged bronze
 Mechanical ratings are available in the unit rating section by size and ratio
 Check with factory for other dimensions
 WINSMITH® reserves the right to change dimensions without prior notice

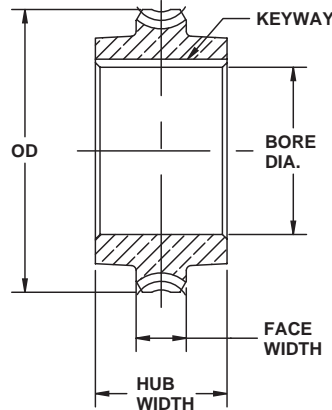
HOLLOW SHAFT GEAR

HOLLOW SHAFT GEAR DIMENSIONS

| SIZE | CD | BORE DIA. | KEYWAY | HUB WIDTH | SIZE | CD | BORE DIA. | KEYWAY | HUB WIDTH |
|------|-------|---------------|-----------|-------------|------|-------|---------------|-------------|-------------|
| 917 | 1.750 | 1.4956/1.4964 | 1/4 x 1/8 | 1.922/1.918 | 930 | 3.000 | 2.6885/2.6879 | 5/16 x 5/32 | 1.501/1.499 |
| 920 | 2.000 | 2.0008/1.9997 | 1/4 x 1/8 | 1.896/1.892 | 935 | 3.500 | 2.8760/2.8754 | 3/8 x 3/16 | 3.001/2.999 |
| 924 | 2.375 | 2.2496/2.2507 | 1/4 x 1/8 | 1.377/1.373 | 943 | 4.250 | 3.9995/4.0005 | 3/8 x 3/16 | 2.251/2.249 |
| 926 | 2.625 | 2.4994/2.5005 | 1/4 x 1/8 | 2.020/2.016 | | | | | |

GEAR OD & FACE WIDTH

| SIZE | RATIO | | | | | | | | | | | | | | SIZE |
|------|-------|-------------------------|-------|-------------------------|-------|-------------------------|-------|-------------------------|-------|-------------------------|-------|-------------------------|-------|-------------------------|------|
| | 4 | | 5 | | 7.5 | | 10 | | 15 | | 20 | | 25 | | |
| | OD | FACE WIDTH HOLLOW SHAFT | OD | FACE WIDTH HOLLOW SHAFT | OD | FACE WIDTH HOLLOW SHAFT | OD | FACE WIDTH HOLLOW SHAFT | OD | FACE WIDTH HOLLOW SHAFT | OD | FACE WIDTH HOLLOW SHAFT | OD | FACE WIDTH HOLLOW SHAFT | |
| 913 | 1.966 | NA | 2.070 | NA | 2.200 | NA | 2.200 | NA | 2.200 | NA | 2.200 | NA | 2.200 | NA | 913 |
| 917 | 2.300 | .75 | 2.730 | .75 | 2.941 | .60 | 3.080 | .60 | 3.080 | .60 | 3.080 | .60 | 3.080 | .60 | 917 |
| 920 | 3.487 | .65 | 3.120 | 1.00 | 3.361 | .65 | 3.560 | .65 | 3.560 | .65 | 3.560 | .65 | 3.560 | .65 | 920 |
| 924 | 4.009 | .91 | 3.660 | .91 | 4.009 | .91 | 4.240 | .91 | 4.240 | .91 | 4.240 | .91 | 4.240 | .91 | 924 |
| 926 | 3.766 | 1.00 | 4.060 | 1.00 | 4.431 | .85 | 4.700 | .85 | 4.700 | .85 | 4.700 | .85 | 4.700 | .85 | 926 |
| 930 | 4.484 | 1.31 | 4.640 | 1.31 | 5.087 | .75 | 5.390 | .75 | 5.390 | .75 | 5.390 | .75 | 5.390 | .75 | 930 |
| 935 | 5.400 | 1.40 | 5.364 | 1.50 | 6.035 | 1.50 | 6.035 | 1.50 | 6.035 | 1.50 | 6.035 | 1.50 | 6.035 | 1.50 | 935 |
| 943 | 7.100 | 1.38 | 7.100 | 1.38 | 7.100 | 1.38 | 7.100 | 1.38 | 7.100 | 1.38 | 7.100 | 1.38 | 7.100 | 1.38 | 943 |

| SIZE | RATIO | | | | | | | | | | | | SIZE |
|------|-------|-------------------------|-------|-------------------------|-------|-------------------------|-------|-------------------------|-------|-------------------------|-------|-------------------------|------|
| | 30 | | 40 | | 50 | | 60 | | 80 | | 100 | | |
| | OD | FACE WIDTH HOLLOW SHAFT | OD | FACE WIDTH HOLLOW SHAFT | OD | FACE WIDTH HOLLOW SHAFT | OD | FACE WIDTH HOLLOW SHAFT | OD | FACE WIDTH HOLLOW SHAFT | OD | FACE WIDTH HOLLOW SHAFT | |
| 913 | 2.200 | NA | 2.200 | NA | 2.200 | NA | 2.200 | NA | 2.200 | NA | 2.200 | NA | 913 |
| 917 | 3.080 | .60 | 3.080 | .60 | 3.080 | .60 | 3.080 | .60 | 3.080 | .60 | 3.080 | .60 | 917 |
| 920 | 3.560 | .65 | 3.560 | .65 | 3.560 | .65 | 3.560 | .65 | 3.560 | .65 | 3.560 | .65 | 920 |
| 924 | 4.240 | .91 | 4.240 | .91 | 4.240 | .91 | 4.240 | .91 | 4.240 | .91 | 4.240 | .91 | 924 |
| 926 | 4.700 | .85 | 4.700 | .85 | 4.700 | .85 | 4.700 | .85 | 4.700 | .85 | 4.700 | .85 | 926 |
| 930 | 5.390 | .75 | 5.390 | .75 | 5.390 | .75 | 5.390 | .75 | 5.390 | .75 | 5.390 | .75 | 930 |
| 935 | 6.035 | 1.50 | 6.035 | 1.50 | 6.035 | 1.50 | 6.035 | 1.50 | 6.035 | 1.50 | 6.035 | 1.50 | 935 |
| 943 | 7.100 | 1.38 | 7.100 | 1.38 | 7.100 | 1.38 | 7.100 | 1.38 | 7.100 | 1.38 | 7.100 | 1.38 | 943 |

Material—Chill cast or forged bronze
 Mechanical ratings are available in the unit rating section by size and ratio
 Check with factory for other dimensions
 WINSMITH[®] reserves the right to change dimensions without prior notice

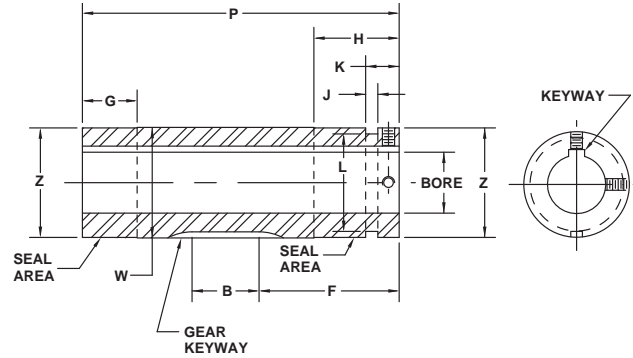

HOLLOW SLOW SPEED SHAFT DIMENSIONS

| SIZE | CD | GEAR KEYWAY | B FULL DEPTH | F | G | H | J | K | L | P | W | Z +.000 -0.001 | BORE +.002 -0.000 | KEYWAY | SIZE |
|------|-------|-------------|--------------|------|------|------|-----|-----|------|------|---------------|----------------|-------------------|------------|------|
| 917 | 1.750 | 1/4 x 1/8 | 1.75 | 2.38 | 1.00 | 1.63 | .25 | .63 | 1.25 | 5.88 | 1.4971/1.4965 | 1.492 | 1.000 | 1/4 x 1/8 | 917 |
| 920 | 2.000 | 1/4 x 1/8 | 1.88 | 2.44 | 1.00 | 1.50 | .25 | .63 | 1.75 | 6.25 | 2.0015/2.0010 | 1.997 | 1.438 | 3/8 x 1/8 | 920 |
| 924 | 2.375 | 1/4 x 1/8 | 1.38 | 2.88 | 1.13 | 1.75 | .25 | .68 | 2.00 | 6.50 | 2.2515/2.2510 | 2.247 | 1.500 | 3/8 x 3/16 | 924 |
| 926 | 2.625 | 1/4 x 1/8 | 2.00 | 2.69 | 1.13 | 1.81 | .25 | .68 | 2.25 | 6.69 | 2.5015/2.5010 | 2.497 | 1.688 | 3/8 x 3/16 | 926 |
| 930 | 3.000 | 5/16 x 5/32 | 1.50 | 3.31 | 1.19 | 2.06 | .25 | .81 | 2.44 | 7.25 | 2.690/2.689 | 2.625 | 1.938 | 1/2 x 3/16 | 930 |
| 935 | 3.500 | 3/8 x 3/16 | 1.75 | 3.56 | 1.00 | 1.88 | .25 | .94 | 2.50 | 8.00 | 2.8775/2.8765 | 2.873 | 2.188 | 1/2 x 1/8 | 935 |
| 943 | 4.250 | 3/8 x 3/16 | 2.25 | 3.25 | 1.69 | 1.69 | .25 | .56 | 3.38 | 8.75 | 4.0025/4.0015 | 3.875 | 2.750 | 5/8 x 5/16 | 943 |

Material—Low carbon, free machining steel
 Maximum available bore diameter is shown. Check with factory for smaller bore sizes.
 Use this style shaft with hollow shaft gears
 Check with factory for other dimensions
 WINSMITH® reserves the right to change dimensions without prior notice

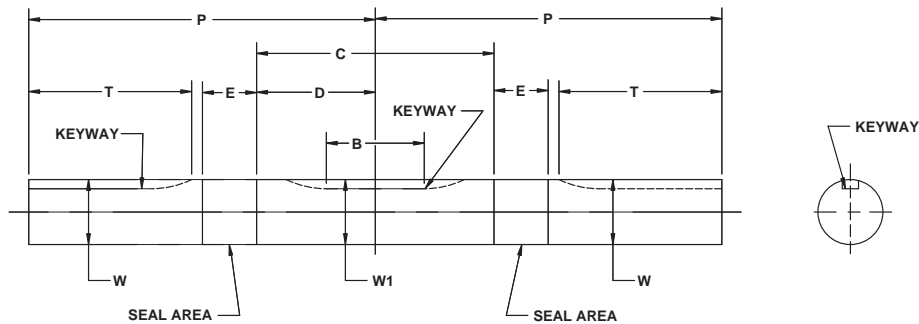

SOLID SLOW SPEED SHAFT DIMENSIONS

| SIZE | CD | KEYWAY | B FULL DEPTH | C | D | E | P | T | W +.000 -0.001 | W1 +.0000 -0.0005 | SIZE |
|------|-------|-------------|--------------|------|------|------|------|------|----------------|-------------------|------|
| 913 | 1.333 | 3/16 x 3/32 | 1.13 | 2.76 | 1.38 | .75 | 4.00 | 1.88 | .750 | .7515 | 913 |
| 917 | 1.750 | 1/4 x 1/8 | 1.72 | 3.12 | 1.56 | .88 | 4.75 | 2.31 | 1.000 | 1.0015 | 917 |
| 920 | 2.000 | 1/4 x 1/8 | 1.72 | 3.12 | 1.56 | .88 | 4.75 | 2.31 | 1.000 | 1.0015 | 920 |
| 924 | 2.375 | 1/4 x 1/8 | 1.38 | 4.00 | 2.00 | .88 | 5.50 | 2.63 | 1.250 | 1.2515 | 924 |
| 926 | 2.625 | 1/4 x 1/8 | 1.38 | 4.00 | 2.00 | .88 | 5.50 | 2.63 | 1.250 | 1.2515 | 926 |
| 930 | 3.000 | 5/16 x 5/32 | 1.50 | 4.25 | 2.13 | 1.00 | 5.88 | 2.75 | 1.375 | 1.3765 | 930 |
| 935 | 3.500 | 3/8 x 3/16 | 2.06 | 5.00 | 2.50 | .88 | 7.00 | 3.63 | 1.750 | 1.7515 | 935 |
| 943 | 4.250 | 1/2 x 1/4 | 2.00 | 5.50 | 2.75 | 1.00 | 8.00 | 4.19 | 2.000 | 2.0015 | 943 |

Material—Low carbon, free machining steel
 Single or double extension shafts available
 Use this style shaft with solid shaft gears
 Check with factory for other dimensions
 WINSMITH® reserves the right to change dimensions without prior notice