

MODEL†	913	917	920	924	926	930	935	943
DV SHIPPING WEIGHT	14	22	23	42	47	60	86	123
MDV SHIPPING WEIGHT‡	17	24	26	46	51	64	90	128
CDV SHIPPING WEIGHT‡	20	28	30	51	56	70	96	133
APPROX. OIL CAPACITY (PINTS)	.3	.6	.7	1.4	1.7	2.3	2.9	3.6

MODEL DV  
Assembly RU



GEAR RATIOS AVAILABLE 4:1 THRU 100:1\*\*  
 TORQUE AND HP RATINGS/OVERHUNG LOAD RATINGS . . . . . PAGES 20-117  
 MOUNTING POSITIONS . . . . . PAGE 187  
 SERVICE FACTORS . . . . . PAGES 228-230  
 HYDRAULIC MOTOR ADAPTERS . . . . . PAGE 174

†Weights are approximate and include shipping carton.  
 ‡Weight given for 48C thru 145TC. For 182/4TC and 213/5TC add 4 lbs.  
 \*\*80:1 and 100:1 not available in Size 913.

## DIMENSIONS

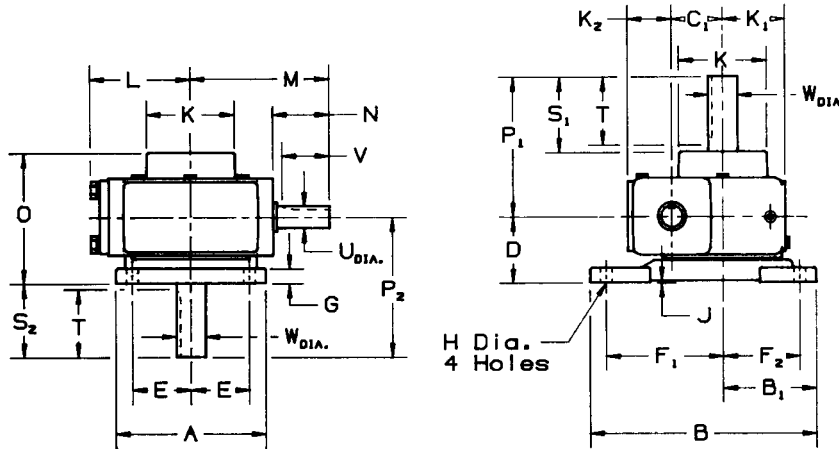

## SPEED REDUCER DIMENSIONS (IN INCHES)

SIZE	A	B	B <sub>1</sub>	C <sub>1</sub>	D	E	F <sub>1</sub>	F <sub>2</sub>	G	H	J	K	K <sub>1</sub>	K <sub>2</sub>	L	M	O	P <sub>1</sub>	P <sub>2</sub>	HIGH SPEED SHAFT				SLOW SPEED SHAFT				SIZE	
																				U*	N	V	KEYWAY	W*	S <sub>1</sub>	S <sub>2</sub>	T		KEYWAY
913	4.25	6.60	2.69	1.333	2.25	1.75	3.53	2.31	.38	.281	.13	2.25	1.75	1.25	2.83	4.12	4.19	4.00	4.00	.625	1.81	1.63	.19 x .09	.750	2.06	1.75	1.88	.19 x .09	913
917	5.13	7.75	3.19	1.750	2.25	2.00	4.00	2.63	.50	.406	.06	2.50	2.13	1.50	3.44	4.75	4.44	4.75	4.75	.750	1.94	1.69	.19 x .09	1.000	2.56	2.50	2.31	.25 x .13	917
920	5.13	8.50	3.56	2.000	2.25	2.00	4.38	3.00	.50	.406	.06	2.50	2.13	1.50	3.44	5.00	4.44	4.75	4.75	.750	2.19	1.75	.19 x .09	1.000	2.56	2.50	2.31	.25 x .13	920
924	6.88	8.88	3.44	2.375	3.50	2.88	4.88	2.88	.50	.406	.13	3.25	2.88	2.00	4.50	6.50	6.13	5.75	6.38	1.000	2.75	2.38	.25 x .13	1.250	3.12	2.88	2.75	.25 x .13	924
926	6.88	9.44	3.63	2.625	3.63	2.88	5.25	2.88	.50	.406	.13	3.50	3.13	2.13	4.50	6.50	6.26	5.63	6.38	1.000	2.75	2.38	.25 x .13	1.250	3.00	2.75	2.75	.25 x .13	926
930	8.88	10.63	4.25	3.000	3.75	3.81	5.75	3.63	.63	.563	.13	3.50	3.50	2.50	4.63	7.00	6.75	6.19	6.75	1.000	3.06	2.38	.25 x .13	1.375	3.19	3.00	3.06	.31 x .16	930
935	9.75	11.50	5.00	3.500	3.75	4.25	5.88	4.38	.63	.563	.13	4.13	4.00	2.63	5.06†	7.38	7.00	7.00	7.00	1.000	2.31	2.50	.25 x .13	1.750	3.75	3.25	3.63	.38 x .19	935
943	9.63	11.00	4.81	4.250	4.75	4.13	5.50	4.13	.63	.563	.13	4.75	4.38	2.88	5.88‡	8.19	8.38	8.00	8.00	1.250	2.31	2.50	.25 x .13	2.000	4.38	3.25	4.19	.50 x .25	943

\*Shaft diameter tolerance +.000 -.001. For construction purposes send for Certified Dimension Sheets.  
 †L dimension equals 5.46 on MDV models.  
 ‡L dimension equals 6.28 on MDV models.

For larger sizes see C-Line Catalog 100 or D-90<sup>®</sup> TYPE DE<sup>®</sup> Catalog 190.

## SHAFT ARRANGEMENTS AND RELATIVE SHAFT ROTATIONS

AutoCAD<sup>®</sup> drawing for these models available in WINSMITH<sup>®</sup>'s Gear Graphics.

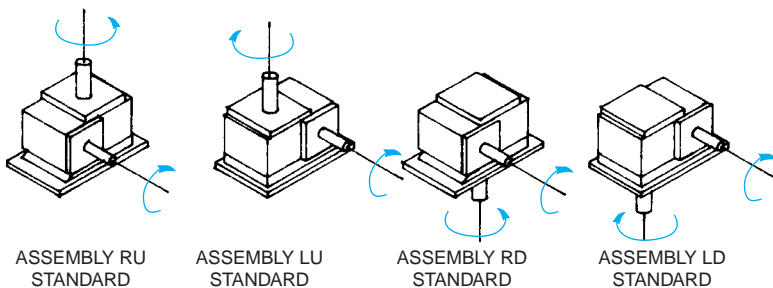

The input shaft may be driven in either direction.

**MODEL MDV**  
Assembly RU



**MODEL CDV**  
Assembly RU

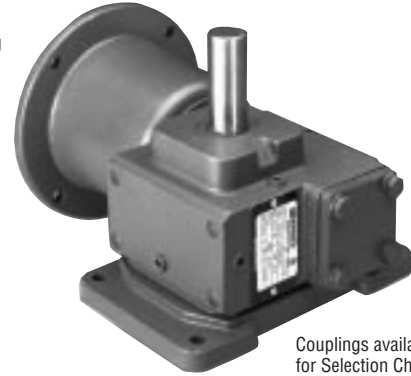

Couplings available, see page 184 for Selection Chart.

## DIMENSIONS

See table for input shaft bore & keyway size.

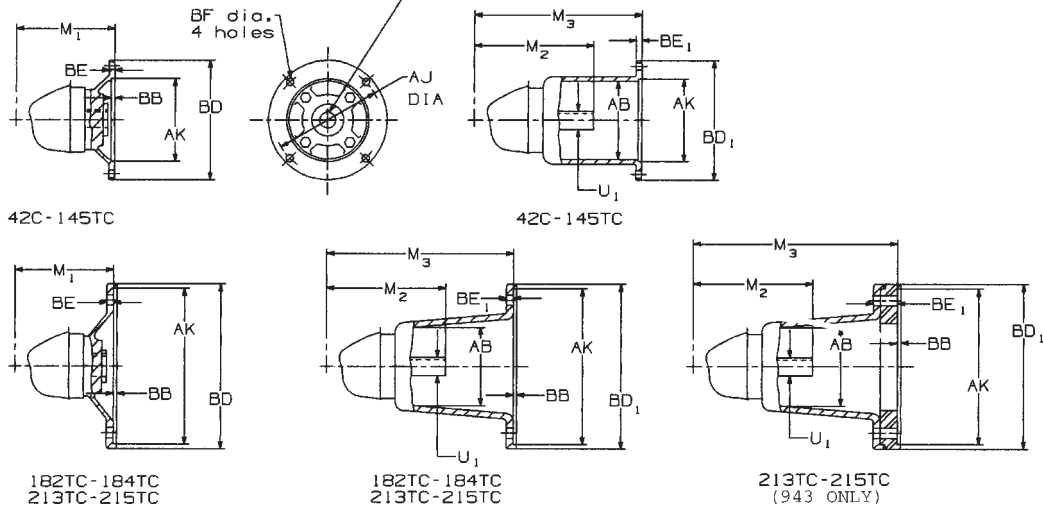

SIZE	HOLLOW INPUT MOTOR ADAPTER				COUPLING STYLE MOTOR ADAPTER														
	M <sub>1</sub> 42C-48C	M <sub>1</sub> 56C-145TC	M <sub>1</sub> 182TC 184TC	M <sub>1</sub> 213TC 215TC	42C-48C			56C-145TC			182TC-184TC			213TC-215TC			M <sub>2</sub> *	U <sub>1</sub> *	KEYWAY
	AB	M <sub>3</sub>	BE <sub>1</sub>	AB	M <sub>3</sub>	BE <sub>1</sub>	AB	M <sub>3</sub>	BE <sub>1</sub>	AB	M <sub>3</sub>	BE <sub>1</sub>							
913	3.56	3.63 $\Delta$	NA	NA	2.50	6.81	.38	3.00	6.75	.31	NA			NA			4.12	.500	.13 x .06
917	4.06	4.06	NA	NA	2.50	7.56	.38	3.75	7.50	.38	3.75	8.44	.50	NA			4.88	.625	.19 x .09
920	4.06	4.06	NA	NA	2.50	7.56	.38	3.75	7.50	.38	3.75	8.44	.50	NA			4.88	.625	.19 x .09
924	NA	5.38	5.38	NA	NA			4.13	9.13	.38	4.25	10.19	.50	NA			6.50	1.000	.25 x .13
926	NA	5.38	5.38	NA	NA			4.13	9.13	.38	4.25	10.19	.50	NA			6.50	1.000	.25 x .13
930	NA	5.56	5.56	NA	NA			4.13	9.75	.38	4.75	10.88	.50	4.75	10.88	.50	7.00	1.000	.25 x .13
935	NA	5.81	5.81	NA	NA			4.13	10.00	.38	4.75	11.13	.50	4.75	11.13	.50	7.38	1.000	.25 x .13
943	NA	6.63	6.63	6.63	NA			4.13	10.81	.38	4.75	11.94	.50	4.75	12.88	1.44	8.19	1.250	.25 x .13

\* Input shaft diameter and length varies from non-motorized model on sizes 913 thru 920.  
 $\Delta$ 56C frame only.

## SHAFT ARRANGEMENTS AND RELATIVE SHAFT ROTATIONS

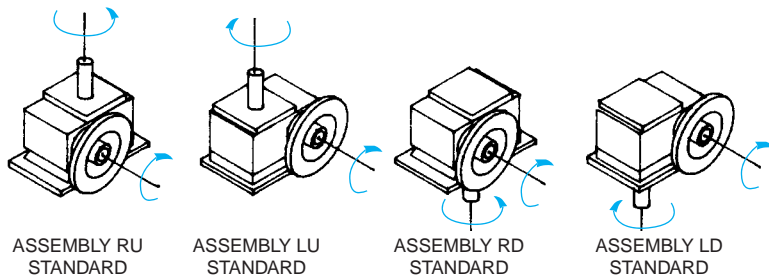

FRAME NO.	42C-48C	56C	143TC 145TC	182TC 184TC	213TC 215TC
AJ	3.75	5.88	5.88	7.25	7.25
AK	3.00	4.50	4.50	8.50	8.50
BB	.19	.19	.19	.19	.19
BD	4.50	6.50	6.50	9.00	9.00
BD <sub>1</sub>	4.50	6.63	6.63	9.00	9.00
BE	.34	.31	.31	.38	.38
BF	.281	.406	.406	.531	.531
KEYWAY	.13 x .06	.19 x .09		.25 x .13	.31 x .16
BORE $^{+.001}_{-.000}$	.5005 $\square$	.6255	.8755	1.1255	1.3755

$\square$  42C frame has .3755 bore, .094 x .047 keyway.

The input shaft may be driven in either direction.